

TEMPLATE NO.

19575
SHT 1 OF 4



Trimco

3528 Emery Street
PO BOX 23277
Los Angeles, CA 90023-0277
(323)262-4191 www.trimcobbw.com
email:info@trimcobbw.com

PRODUCT

1069FP
POCKET DOOR PULL
FULL PRIVACY

INSTALLATION INSTRUCTIONS:

1. OUR STANDARD 1069FP ASSEMBLY WILL WORK WITH A FRAME/WALL OF UP TO 5 1/2" WIDTH - CUSTOMIZED ASSEMBLIES CAN BE MADE FOR WIDTH'S GREATER THAN 5 1/2".
2. TO DETERMINE THE HANDING FOR OUR 1069FP ASSEMBLY, REFER TO SHEET 4.
3. PREPARE DOOR AND FRAME AS INDICATED ON SHEET 2 OR 3 DEPENDING UPON DOOR THICKNESS.
(STRIKE PREPARATION IS THE SAME REGARDLESS)
4. INSERT DOOR PULL AND INSTALL USING QUANTITY FOUR (4) #8X1-5/8" FH PH DRYWALL SCREWS (SUPPLIED)
5. INSTALL STRIKE USING TWO (2) #8X3/4" FH WS (SUPPLIED) THEN TEST UNIT.
6. INSTALL LOCK/UNLOCK DECAL AS SHOWN.
7. INSTALL SLIDE DECALS AS SHOWN (SEE SHEET 4)

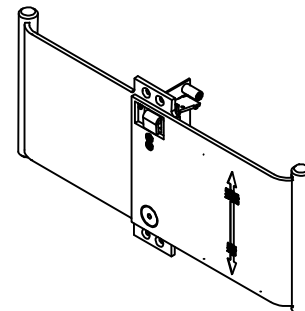

LH SHOWN

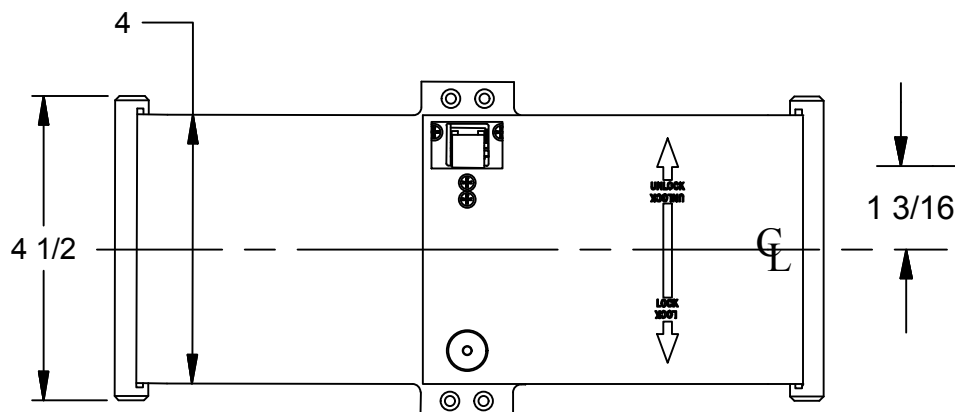

EXTERIOR (RIGID)

INTERIOR (LATCHING)

1069FP POCKET DOOR PULL

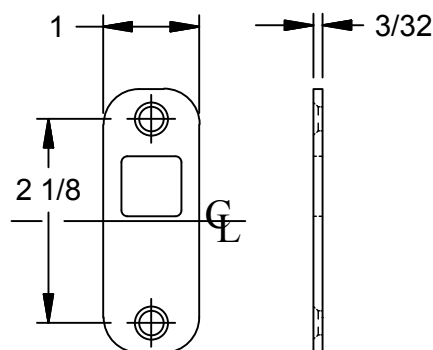

STRIKE

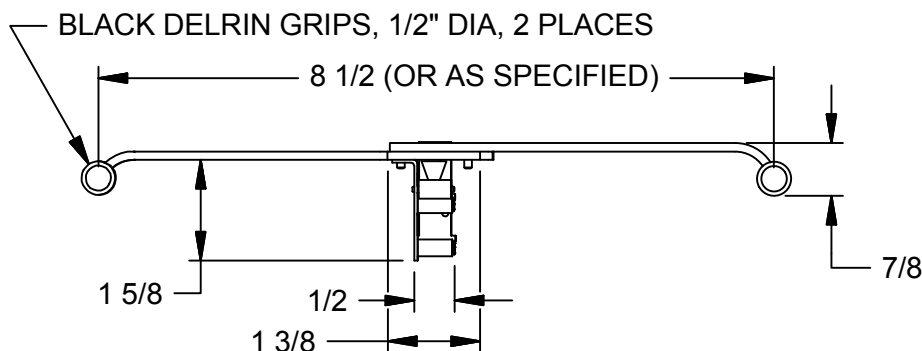

BLACK DELRIN GRIPS, 1/2" DIA, 2 PLACES

SHEET 2 OF 4 DOOR PREP FOR 1-3/8" WOOD DOOR

SHEET 3 OF 4 DOOR PREP FOR 1-3/4" WOOD DOOR AND WIDER

Revision Record:
Created 03-13-13, SGH/JG
Added 7/8 dim to sheet 1 of 3, SGH/JG 06/25/13
Removed emergency access tool on sheet 2 and added to sheet 3, SGH/JG 07/03/13
Sheet 1, Added note 4 and lock/unlock decal, Sheet 1, 1 5/8 was: 1 1/2, SGH/JG 11/15/13
Sheet 1, Added new notes 1 & 2. Renumbered notes 3 thru 6. Added sheet 4 of 4, SGH/JG, 01/17/14
Sheet 1, Added black delrin grip callout, Sheet 4, Added "customized width and "Max width note,
Rotated iso view for clarity, SGH/JG, 01/22/14
Sheets 2 of 4 and 3 of 4, 1 3/4 was: 1 7/8, 3/16 was: 3/8, SGH/JG, 04/16/14
Added note 7 to sheet 1 of 4.
Added slide decal and view to sheet 4 of 4, SGH/JG, 06/24/14

NOTE: This template is provided for use only on the job for which it was requested. Trimco reserves the right to make design changes without notice. Trimco will not be responsible for errors or damage caused by the use of out-of-date templates.

DATE

06/24/14

TEMPLATE NO.

19575
SHT 2 OF 4



Trimco

3528 Emery Street
PO BOX 23277
Los Angeles, CA 90023-0277
(323)262-4191 www.trimcobbw.com
email:info@trimcobbw.com

PRODUCT

1069FP
POCKET DOOR PULL
FULL PRIVACY

PREP FOR STRIKE
IN WOOD FRAME

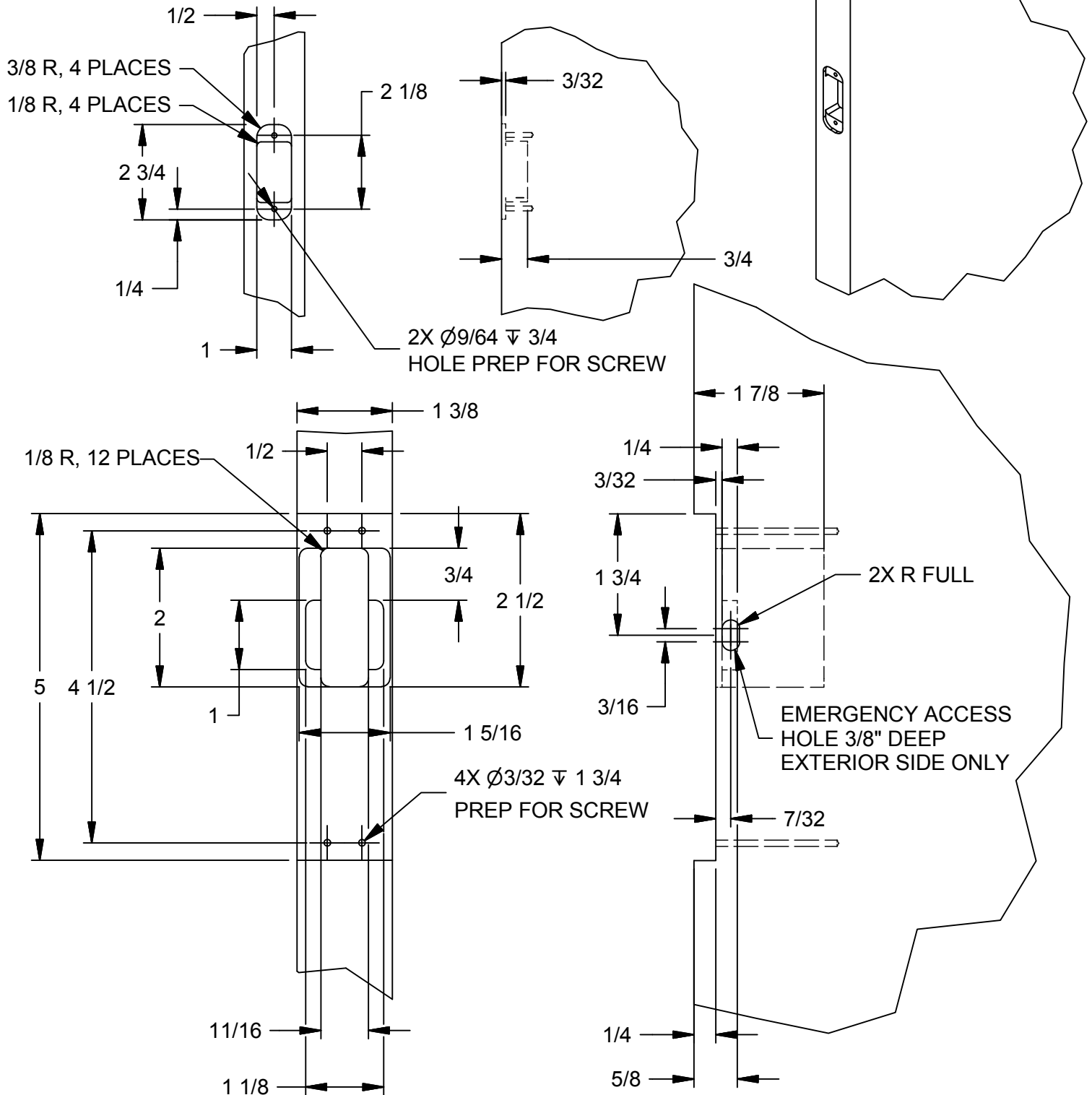

DOOR PREP FOR 1-3/8" WOOD DOOR - CENTER PATTERN IN DOOR THICKNESS

NOTE: This template is provided for use only on the job for which is was requested.
Trimco reserves the right to make design changes without notice. Trimco will
not be responsible for errors or damage caused by the use of out-of-date templates.

DATE

06/24/14

TEMPLATE NO.

19575
SHT 3 OF 4



Trimco

3528 Emery Street
PO BOX 23277
Los Angeles, CA 90023-0277
(323)262-4191 www.trimcobbw.com
email:info@trimcobbw.com

PRODUCT

1069FP
POCKET DOOR PULL
FULL PRIVACY

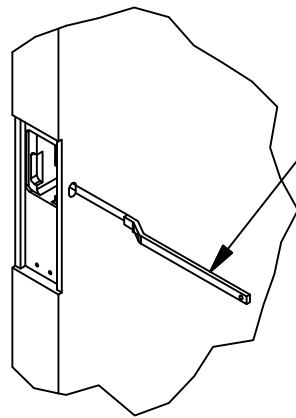

EMERGENCY
ACCESS TOOL

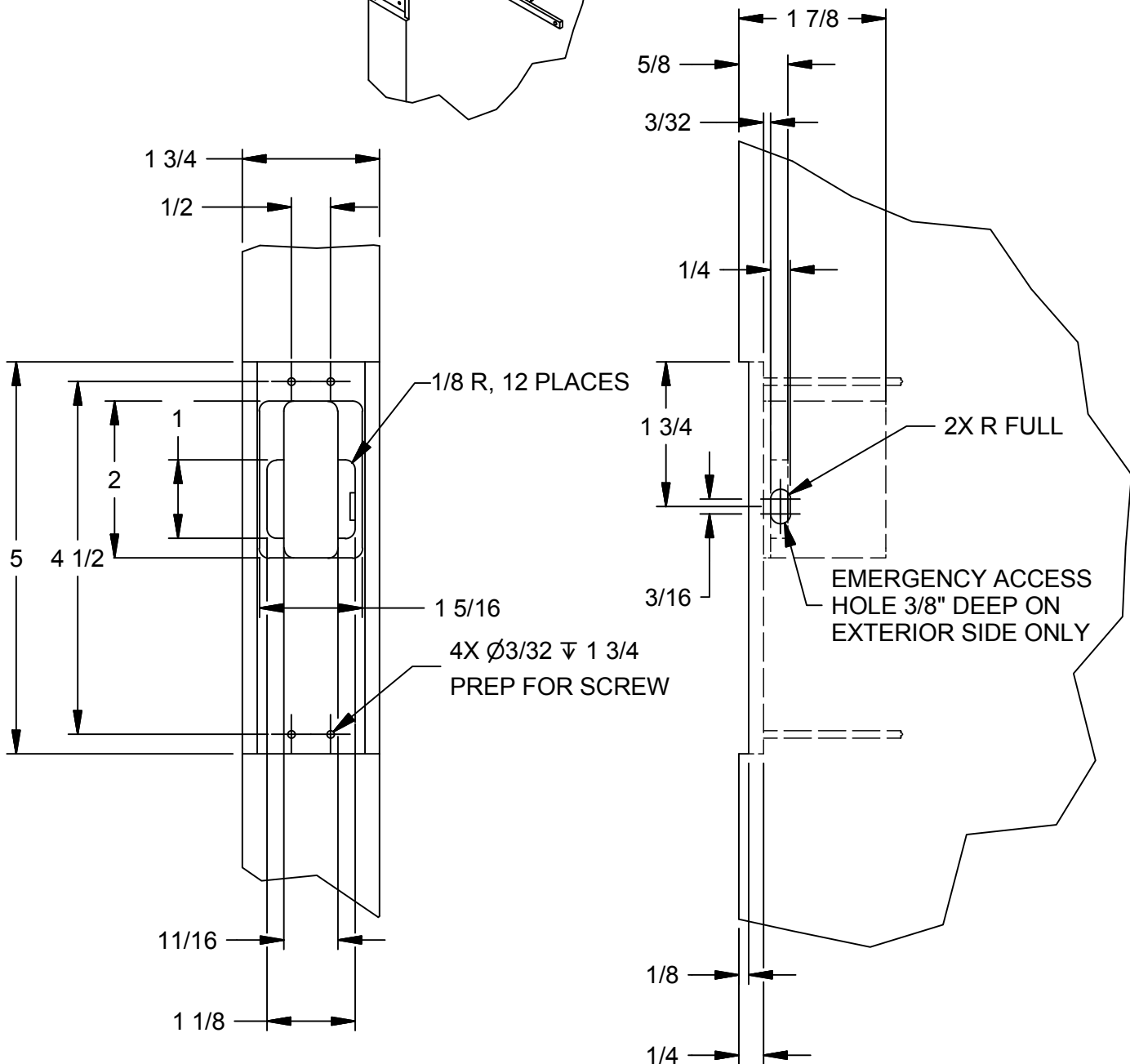

DOOR PREP FOR 1-3/4" WOOD DOOR AND WIDER
CENTER PATTERN IN DOOR THICKNESS

NOTE: This template is provided for use only on the job for which is was requested.
Trimco reserves the right to make design changes without notice. Trimco will
not be responsible for errors or damage caused by the use of out-of-date templates.

DATE

06/24/14

TO DETERMINE THE HANDING ON THE 1069FP,
CONSIDER THE FOLLOWING:

1. THE RIGID HANDLE ON THE 1069FP IS ON THE EXTERIOR.
2. THE LATCHING HANDLE (THAT LOCKS THE DOOR) IS LOCATE ON THE INTERIOR SIDE.
3. CLOSE THE POCKET DOOR.
4. IF THE RIGID PART OF THE HANDLE IS ON THE LEFT AND YOU GRAB IT TO SLIDE THE DOOR TO THE RIGHT INTO THE POCKET ON THE WALL, THIS IS A RIGHT HANDED POCKET DOOR.
5. IF THE RIGID PART OF THE HANDLE IS ON THE RIGHT AND YOU GRAB IT TO SLIDE THE DOOR TO THE LEFT INTO THE POCKET ON THE WALL, THIS IS A LEFT HANDED POCKET DOOR.

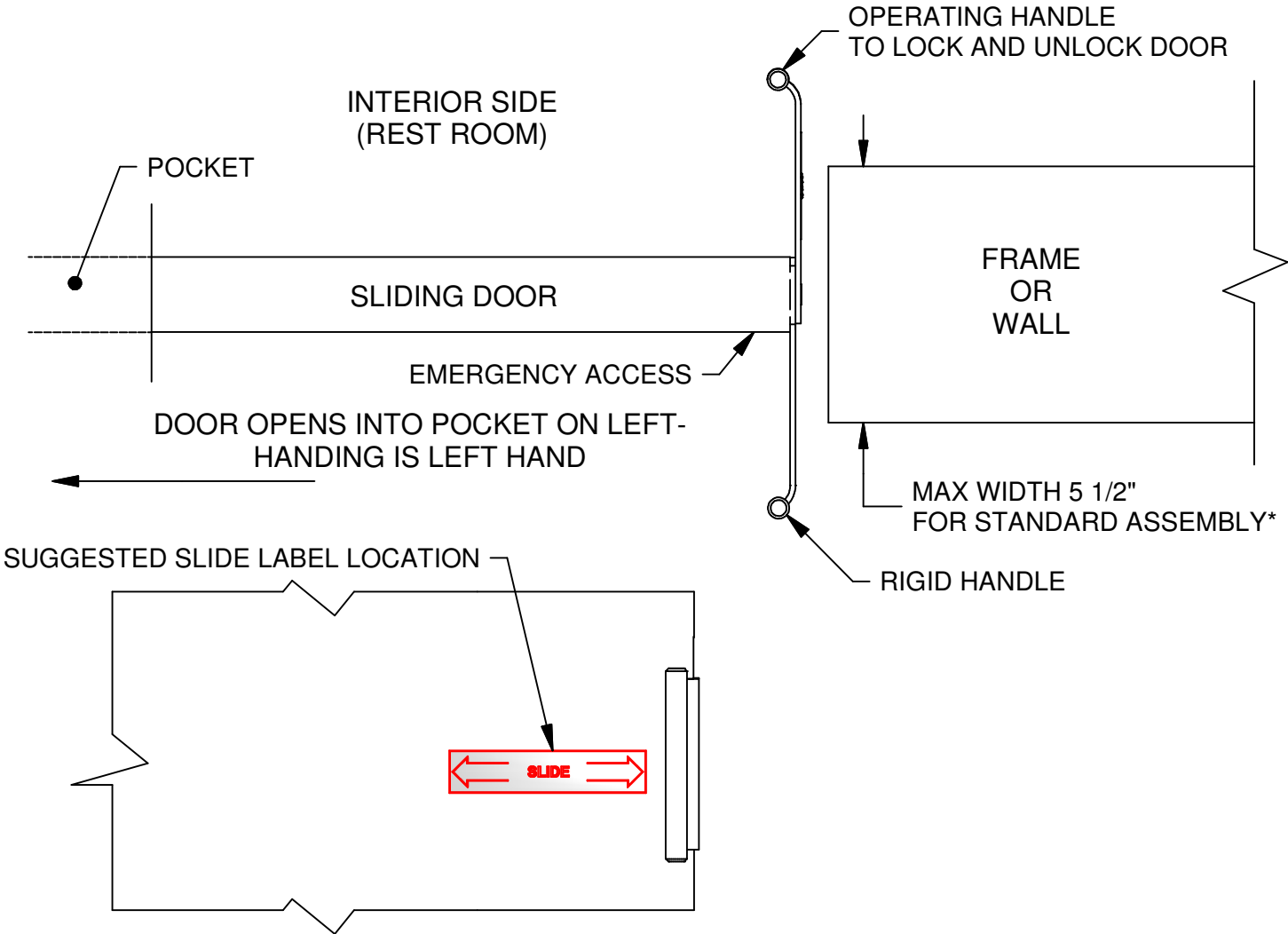
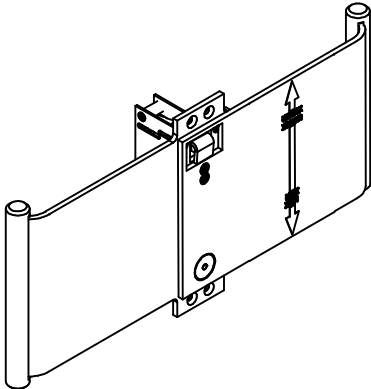

*CUSTOMIZED ASSEMBLIES CAN BE MADE FOR WIDTH'S GREATER THAN 5 1/2"

HANDING IS REQUIRED SO THAT THE OPERATING HANDLE IS ON
THE INTERIOR SIDE SO WHEN USED WILL LOCK THE DOOR

NOTE: THE EMERGENCY ACCESS IS ALSO LOCATED ON THE EXTERIOR SIDE NEXT TO THE RIGID HANDLE